

PANTRY SPOTLIGHT: THE NEW LOVE CENTER

The New Love Center is located in Lycoming County and has been a HPI partner since 2020. This location has two pantries within the same building. One is a regular choice pantry, and the other is a Fresh Food Farmacy. The Fresh Food Farmacy is operated in collaboration with Geisinger. If neighbors screen positive for food insecurity and diabetes, a doctor can refer them to this pantry. All the food in the pantry is low sugar and low sodium. All grains are whole grains and there is a wide variety of fresh produce. Neighbors are connected to a Geisinger registered dietician for any concerns they have about their blood sugar levels or dietary questions. The program has proven successful and many patients A1C levels have decreased!

WHAT'S IN THIS MONTH'S ISSUE:

- Pantry Spotlight
- Choice Pantry Webinar
- New Neighbor Resource
- HPI Assessment Update



UPCOMING: CHOICE PANTRY WEBINAR

The Nutrition Team at the Central PA Food Bank will be hosting a Choice Pantry Webinar on Thursday, March 27th at 1PM. We will cover the benefits of choice models for both neighbors and staff, different types of models, and common questions and concerns.



The recording will be sent out to registrants if you are unable to join live.

View our Choice Pantry Toolkit ahead of the meeting.

NEW NEIGHBOR RESOURCE

We have a new handout for neighbors on how to safely defrost and repackage meat. We hope this handout encourages our pantry guests to take home large packages of meat.

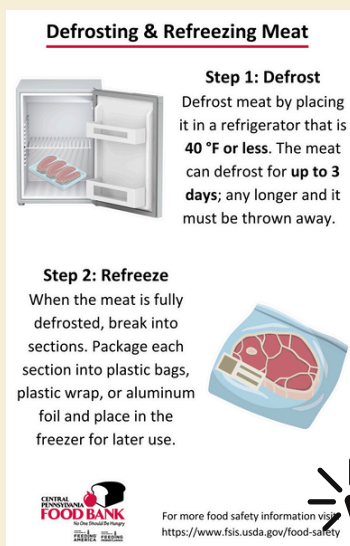

CHANGES TO THE HPI ASSESSMENT

The inventory portion of our assessment will be changing this spring. We will continue to assess based on availability, quantity and quality. However, our quality scores will be based on the HER nutrition guidelines (the red, yellow and green ranking system).

Please bare with us as we navigate this new system. We do not feel that your scores will change significantly, but we may need more time to assess your inventory!

